

LA PORTE INDEPENDENT SCHOOL DISTRICT

ROBERT H. WILLIAMS, Jr.
Superintendent of Schools

301 E. Fairmont Parkway
La Porte, Texas 77571
(713) 471-0950

May 24, 1983

BOARD OF TRUSTEES

President
BRENDA TYRRELL

Vice President
DR. RUEDE WHEELER

Secretary
LEO A RIZZUTO, Sr.

Trustees
JERROLD L. GRAHAM
D.O. LAIRD
KYLAN LEWIS
JOHN PAUL ZEMANEK

C.A. Jacobson, President
Space Center Rotary Club
c/o Mc Donnell Douglas Corporation
16441 Space Center Blvd.
Houston, TX 77058

Dear Chuck:

This letter is in reference to your recent request regarding a change in the territorial boundary between the La Porte and Space Center Rotary Clubs. Our Board of Directors met on two occasions and thoroughly discussed all aspects of the matter. The unanimous decision was to leave the boundary as it currently exists.

A major factor in the decision is the Rotary International rule change which allows individuals to join Rotary Clubs in adjacent communities. Under the new rule, Seabrook residents would have a choice of membership in the Space Center or La Porte Clubs.

Since the founding of the Space Center Rotary Club, a close spirit of cooperation has prevailed between our clubs. We look forward to a continued strong relationship between two of the finest clubs in District 589.

Sincerely,

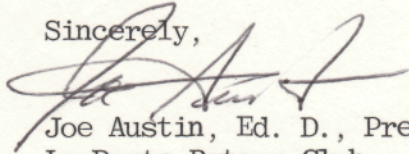

Joe Austin, Ed. D., President
La Porte Rotary Club

/jw

cc: Dick Chandler



ROTARY INTERNATIONAL

Service Above Self - He Profits Most Who Serves Best

1600 RIDGE AVENUE • EVANSTON, ILLINOIS 60201, U.S.A.

Tel: 312/328-0100 • Cable: Interrotary • Telex: 724-465

20 May, 1983

Mr. Charles Hartman
Secretary, The Rotary Club
Space Center (Houston), Texas

Dear Charles:

Thank you for your letter of 16 May concerning the Notification of Action forms.

The Notification of Action forms are enclosed for your use along with a copy of the current territorial limits for the club. Also, the guideline sheet for the Notification of Action forms is enclosed. All pertinent information concerning a change of territorial limits should be forwarded to the district governor for his recommendation.

If we can ever be of further assistance, please do not hesitate to let me know.

With best regards,

A handwritten signature in dark ink, appearing to read "Ron", written over the typed name.

Ronald W. Carlson
Service Supervisor

enclosures



ROTARY INTERNATIONAL

Service Above Self - He Profits Most Who Serves Best

1600 RIDGE AVENUE • EVANSTON, ILLINOIS 60201, U.S.A.
Tel: 312/328-0100 • Cable: Interotary • Telex: 724-465

21 May, 1982

Mr. Charles H. Hartman
Secretary, The Rotary Club
Space Center (Houston), Texas

Dear Charles:

The board of directors of Rotary International has approved the change in territorial limits of your club, effective 20 May 1982.

- * Enclosed is a copy of the "Notification of Action" adopted by your club with the board's approval indicated thereon for your club's records.

The new description of your club's territorial limits now should appear in Article II of your club's constitution.

Sincerely,

A handwritten signature in dark ink, appearing to read "Ron".

Ronald W. Carlson
Service Supervisor

- * enclosure

"World Understanding and Peace Through Rotary"

Rotary International Convention • Dallas, Texas, USA • 6 - 9 June, 1982

ATTACH TO ORIGINAL
one copy of a map
on which the area
involved in the pro-
posed change is
clearly indicated.

Notification of Action Taken by
The Rotary Club of Space Center
(Houston), Texas, U.S.A.

To be submitted
to R.I.
IN TRIPLICATE

TO THE BOARD OF DIRECTORS OF
ROTARY INTERNATIONAL

Date March 1, 1982

Gentlemen:

This is to advise that, in accordance with the provisions of Article XIV, Section 4, of the Standard Rotary Club Constitution, this club at its regular meeting on December 1, 1980, agreed to the revision of its territorial limits as described in Article II, of its constitution as follows:

FROM

North: Fairmont Parkway from the intersection of Red Bluff Road to intersection with the South Belt and thence southwesterly along the South Belt to the Gulf Freeway (U.S. Route 75).

West: Gulf Freeway from South Belt to Clear Creek.

South: Clear Creek from Gulf Freeway to Kirby Road.

East: Kirby Road from Clear Creek to intersection of Red Bluff Road and thence northwesterly along Red Bluff Road to Fairmont Parkway.

TO

Beginning at the intersection of Red Bluff Road and Fairmont Parkway and thence westerly along Fairmont Parkway to South Belt, thence southwesterly along South Belt to the Gulf Freeway (Interstate 45) and thence southeasterly along the Gulf Freeway to Choate Road (FM 2351), and thence southwesterly along Choate Road to Clear Creek, and thence along the meanders of Clear Creek and the center line of Clear Lake to Kirby Road extended into Clear Lake, thence along Kirby Road to Red Bluff Road, and thence northwesterly along Red Bluff Road to the intersection with Fairmont Parkway and the point of beginning.
and submits this amendment of Article II of its Constitution for the approval of the Board of Directors of R.I.

The Rotary Club of Space Center
(Houston), Texas, U.S.A.

It is understood that the adoption of this resolution will not affect the status of any present member of the club

By:

Al Jowid President
Charles Hartman Secretary

Amendment of Article II of the Constitution of the Rotary Club of Space Center
(Houston), Texas, U.S.A. as above stated, approved by the Board of Directors of
Rotary International.

Date 20 May, 1982

Carl E. Remasters
General Secretary
for the General Secretary

May 8, 1982

Mr. Ron Carlson, Service Supervisor
Rotary International
1600 Ridge Avenue
Evanston, Illinois 60201

Dear Ron:

The following, additional information and clarification is provided for your consideration regarding the Space Center Rotary Club request dated March 1, 1982, for an increase in club territory. The purpose of this request is simply to extend the Space Center boundary to the district boundary line, eliminating this small pocket.

The boundary change requested involves an area about two miles wide and three miles long that lies between the Gulf Freeway (I-45) and Clear Creek. It should be noted that at this location, Clear Creek is the boundary between Districts 589 and 591. This area is primarily residential but includes the Baybrook Mall, which is adjacent to the Gulf Freeway. This mall is an office and shopping complex that serves the entire Clear Lake community and is within the normal business pattern of the Space Center Rotary Club.

The additional territory requested lies between the boundaries of the Space Center Rotary Club (District 589) and the Friendswood Rotary Club (District 591) and several miles south of the southern boundary of the Pearland Rotary Club. This additional territory is not large enough to support another club.

In your consideration of this request, the following additional points should be noted:

1. Space Center presently has several members with business locations in the requested area.
2. The nearest Rotary Club is Friendswood, which is not in District 589.

3. The Friendswood Rotary Club (District 591) boundary is primarily the city of Friendswood.

4. The city of Friendswood boundary stops at Clear Creek and does not extend into the requested area.

5. Clear Creek is the boundary between Districts 589 and 591 at this location.

6. Extending the territory of the Space Center Club as requested will cover a pocket not served by any other club in District 589.

7. The requested territory is within the Clear Creek Independent School District, which serves the Clear Lake area. Friendswood has a separate school district.

As District Governor, Rotary International, District 589, I fully endorse and recommend approval of the boundary change for the Space Center Rotary Club as requested in the notification of action dated March 1, 1982.

Sincerely,

Floyd D. Boze

ATTACH TO ORIGINAL
one copy of a map
on which the area
involved in the pro-
posed change is
clearly indicated.

Notification of Action Taken by
The Rotary Club of Space Center
RI District 589

To be submitted
to R.I.
IN TRIPLICATE

TO THE BOARD OF DIRECTORS OF
ROTARY INTERNATIONAL

Date March 1, 1982

Gentlemen:

This is to advise that, in accordance with the provisions of Article XIV, Section 4, of the Standard Rotary Club Constitution, this club at its regular meeting on December 1, 1980, agreed to the revision of its territorial limits as described in Article II, of its constitution as follows:

FROM

North: Fairmont Parkway from the intersection of Red Bluff Road to intersection with the South Belt and thence southwesterly along the South Belt to the Gulf Freeway (Interstate 45)

West: Gulf Freeway from South Belt to Clear Creek.

South: Clear Creek from Gulf Freeway to Galveston Bay.

East: From entrance to Clear Lake up Galveston Bay to Red Bluff Road; thence Red Bluff Road to Fairmont Parkway.

TO

Beginning at the intersection of Red Bluff Road and Fairmont Parkway and thence westerly along Fairmont Parkway to South Belt, thence southwesterly along South Belt to the Gulf Freeway (Interstate 45) and thence southeasterly along the Gulf Freeway to Choate Road (FM 2351), and thence southwesterly along Choate Road to Clear Creek, and thence along the meanders of Clear Creek and Clear Lake to Galveston Bay, and thence northerly along the meanders of Galveston Bay to Red Bluff Road, and thence northwesterly along Red Bluff Road to the intersection with Fairmont Parkway and the point of beginning.

and submits this amendment of Article II of its Constitution for the approval of the Board of Directors of R.I.

The Rotary Club of Space Center
RI District 589

It is understood that the adoption
of this resolution will not affect
the status of any present member
of the club

By:

Al Jowid
Al Jowid President

Charles Hartman
Charles Hartman Secretary

Amendment of Article II of the Constitution of the Rotary Club of _____

_____ as above stated, approved by the Board of Directors of
Rotary International.

Date _____, 19____

General Secretary
or for the General Secretary

Rotary Club of Pearland

P. O. BOX 545
PEARLAND, TEXAS 77581

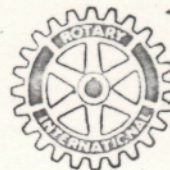

Rotary Club of Space Center
District 589

Gentlemen:

It is the desire of the Pearland Rotary Club Board of Directors that the boundaries of the Pearland Rotary Club remain where they are presently are located. It is not our desire at this time to change any of our boundaries.

Sincerely,

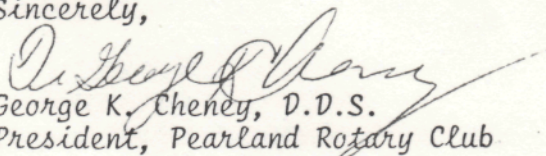
George K. Cheney, D.D.S.
President, Pearland Rotary Club

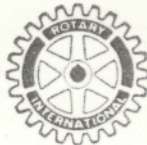

SPACE CENTER ROTARY CLUB

POST OFFICE BOX 58862
HOUSTON, TEXAS 77058

March 1, 1982

TO: BOARD OF DIRECTORS OF ROTARY INTERNATIONAL

After review of the development of the area within the territorial limits of the club over the past ten years, plus the territory served by adjacent clubs and the business and social patterns that have developed within the Clear Lake/Bay Area community, it is requested that the territorial limits of the Rotary Club of Space Center be revised as indicated in the attached Notification of Action dated March 1, 1982, and accompanying map marked to show current territorial limits and the additional territory requested.

It is our belief and understanding that this additional territory west of the Gulf Freeway (Interstate 45) to Clear Creek is not within the territory interests, is not served by and is outside of the business patterns of the Rotary Clubs of Friendswood (District 591) and Pearland (District 589).

We have consulted with the two adjacent clubs. Clear Creek is the boundary between Districts 591 and 589. The eastern boundary of the Rotary Club of Friendswood (District 591) stops at Clear Creek. It is understood that there are no plans for changing district boundaries at this location. The territory of the Rotary Club of Pearland is much farther north of the proposed additional territory for Space Center, and as indicated in the attached letter, Pearland has no interest in changing its territorial boundaries. In discussions with them, they indicated no objections to the revised boundary for Space Center since the proposed new territory is outside of their business interests.

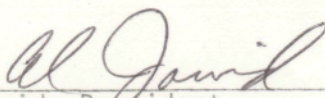
Al Jowid, President
Space Center Rotary Club

Recommended by:

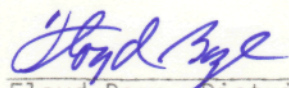
Floyd Boze, District Governor
Rotary International District 589

"SERVICE ABOVE SELF"



ROTARY INTERNATIONAL

Service Above Self - He Profits Most Who Serves Best

1600 RIDGE AVENUE • EVANSTON, ILLINOIS 60201, U.S.A.

Tel: 312/328-0100 • Cable: Interotary • Telex: 724-465

9 March, 1981

Mr. Pete Gist
President, The Rotary Club
Space Center (Houston), Texas

Dear Pete:

Thank you for your letter of 9 February, the Notification of Action forms, the map of the Space Center area, and District Governor Paul Jury's recommendation for the change of territorial limits.

Before the Notification of Action forms can be submitted to the board of directors of R.I., a statement would be needed that the Rotary Club of Space Center (Houston) has consulted with the other clubs in its vicinity (Pearland and Friendswood) and has ascertained that "no conflict" exists concerning the proposed change in territorial limits.

The map of the Clear Creek Independent School District is enclosed for your use, so that the present and proposed territorial limits can be clearly identified. We would suggest the proposed territorial limits be defined as follows:

To: |||
"Beginning at the intersection of Red Bluff Road and Fairmont Parkway and thence westerly along Fairmont Parkway to South Belt, thence southwesterly along South Belt to the Gulf Freeway (Interstate 45) and thence southeasterly along Gulf Freeway to Choate Road (FM 2351), and thence southwesterly along Choate Road to Clear Creek, and thence along the meanders of Clear Creek and Clear Lake to Galveston Bay, and thence northerly along the meanders of Galveston Bay to Red Bluff Road, and thence northwesterly along Red Bluff Road to the intersection with Fairmont Parkway and the point of beginning."

Incidentally, I hope you have made your plans to attend the 72nd annual convention of Rotary International. This great event will take place in South America for the first time in more than thirty years. The 1981 convention will be held in Sao Paulo, Brazil, 31 May to 3 June and will feature a program designed around President Rolf Klärlich's great theme "Take Time to Serve", yet with a uniquely Brazilian flavor, a

"Take Time to Serve"

Rotary International Convention • São Paulo, Brazil • 31 May - 3 June, 1981

Mr. Pete Gist
9 March, 1981
Page Two

true Carnival of Friendship. Reserve your place at the convention by submitting the official registration/housing form with advance payment immediately, if you have not already done so.

If we can be of further assistance, please let me know.

With best regards,

A handwritten signature in blue ink, appearing to read "Ron", is written above the typed name.

Ronald W. Carlson
Service Supervisor

enclosures



SPACE CENTER ROTARY CLUB

POST OFFICE BOX 58862
HOUSTON, TEXAS 77058

February 9, 1981

TO: BOARD OF DIRECTORS OF ROTARY INTERNATIONAL

After review of the development of the area within the territorial limits of the club over the past ten years, plus the territory served by adjacent clubs and the business and social patterns that have developed within the Clear Lake/Bay Area community, it is requested that the territorial limits of the Rotary Club of Space Center be revised as indicated in the attached Notification of Action dated February 9, 1981 and accompanying map marked to show the additional territory requested.

current territorial limits and the
It is our belief and understanding that this additional territory west of the Gulf Freeway (Interstate 45) to Clear Creek is not within the territory, ~~and~~ is not served by and is outside of the business patterns of the Rotary Clubs of Friendswood (District 591) and Pearland (District 589).

interests,

western

Pete Gist, President
Rotary Club of Space Center

Recommended by:

Paul Jury, District Governor
R.I. District 589

"SERVICE ABOVE SELF"

ATTACH TO ORIGINAL
one copy of a map
on which the area
involved in the pro-
posed change is
clearly indicated.

Notification of Action Taken by
The Rotary Club of Space Center

To be submitted
to R.I.
IN TRIPLICATE

TO THE BOARD OF DIRECTORS OF
ROTARY INTERNATIONAL

Date February 9, 1981

Gentlemen:

This is to advise that, in accordance with the provisions of Article XIV, Section 4, of the Standard Rotary Club Constitution, this club at its regular meeting on December 1, 1980, agreed to the revision of its territorial limits as described in Article II, of its constitution as follows:

FROM

OK North: Fairmont Parkway from the intersection of Red Bluff Road to intersection with the South Belt and thence southwesterly along the South Belt to the Gulf Freeway (Interstate 45).

West: Gulf Freeway from South Belt to Clear Creek.

South: Clear Creek from Gulf Freeway to Galveston Bay.

East: From entrance to Clear Lake up Galveston Bay to Red Bluff Road; thence Red Bluff Road to Fairmont Parkway.

TO

North: No change.

West: Gulf Freeway (Interstate 45) from South Belt to Choate Road (FM 2351); thence Choate Road southwesterly to Clear Creek; thence south along Clear Creek to Magnolia Creek.

South: Clear Creek (boundary between Harris and Galveston Counties) from Magnolia Creek to Galveston Bay.

~~East: No change.~~ Amendment of Article II of its Constitution for the approval of the Board of Directors of R.I.

The Rotary Club of Space Center

It is understood that the adoption of this resolution will not affect the status of any present member of the club

By:

Pete Gist 2/17/81
Pete Gist President

Charles Hartman 2/18/81
Charles Hartman Secretary

Amendment of Article II of the Constitution of the Rotary Club of _____

_____ as above stated, approved by the Board of Directors of
Rotary International.

Date _____, 19__

General Secretary
or for the General Secretary



ROTARY INTERNATIONAL

Service Above Self - He Profits Most Who Serves Best

1600 RIDGE AVENUE • EVANSTON, ILLINOIS 60201, U.S.A.

Tel: 312/328-0100 • Cable: Interotary • Telex: 724-465

26 November, 1980

Mr. C. E. Gist
President, The Rotary Club
Space Center (Houston), Texas

Dear Pete:

Through the courtesy of District Governor Paul Jury, we have received the proposed changes of the territorial limits and the map of the area.

- * We are enclosing the Notification of Action forms for your use along with a guideline sheet for changing the territorial limits of your club. These forms need to be completed before the proposed territorial limits can be submitted to the board of directors.

We would appreciate a more detailed map of the Houston area outlining the current territorial limits and the proposed territorial limits.

If we can be of further assistance, please let us know.

With best regards,

A handwritten signature in cursive script, appearing to read "Ron".

Ronald W. Carlson
Service Supervisor

- * enclosures

"Take Time to Serve"

Rotary International Convention • São Paulo, Brazil • 31 May - 3 June, 1981

PROPOSED CHANGES OF TERRITORIAL LIMITS
FOR ROTARY CLUB OF SPACE CENTER
R.I. DISTRICT 589

Present territorial limits of the Rotary Club of Space Center are as follows:

- North: Fairmont Parkway from the intersection of Red Bluff Road to intersection with the South Belt and thence southwesterly along the South Belt to the Gulf Freeway (Interstate 45).
- West: Gulf Freeway from South Belt to Clear Creek.
- South: Clear Creek from Gulf Freeway to Galveston Bay.
- East: From entrance to Clear Lake up Galveston Bay to Red Bluff Road; thence Red Bluff Road to Fairmont Parkway.

After a review of the development of the area within the territorial limits of the club over the past ten years, plus the territory served by adjacent clubs and the business and social patterns that have developed within the Clear Lake/Bay Area community, it is requested that the territorial limits of the Rotary Club of Space Center be revised as follows:

- North: No change.
- West: Gulf Freeway (Interstate 45) from South Belt to Choate Road (FM 2351); thence Choate Road southwesterly to Clear Creek; thence south along Clear Creek to Magnolia Creek.
- South: Clear Creek (boundary between Harris and Galveston Counties) from Magnolia Creek to Galveston Bay.
- East: No change.

It is our belief and understanding that this additional territory west of the Gulf Freeway (Interstate 45) to Clear Creek is not within the territory, and is not served by and is outside of the business patterns of the Rotary Clubs of Friendswood (District 591) and Pearland (District 589).

The requested additional territory is the shaded area on the attached map.

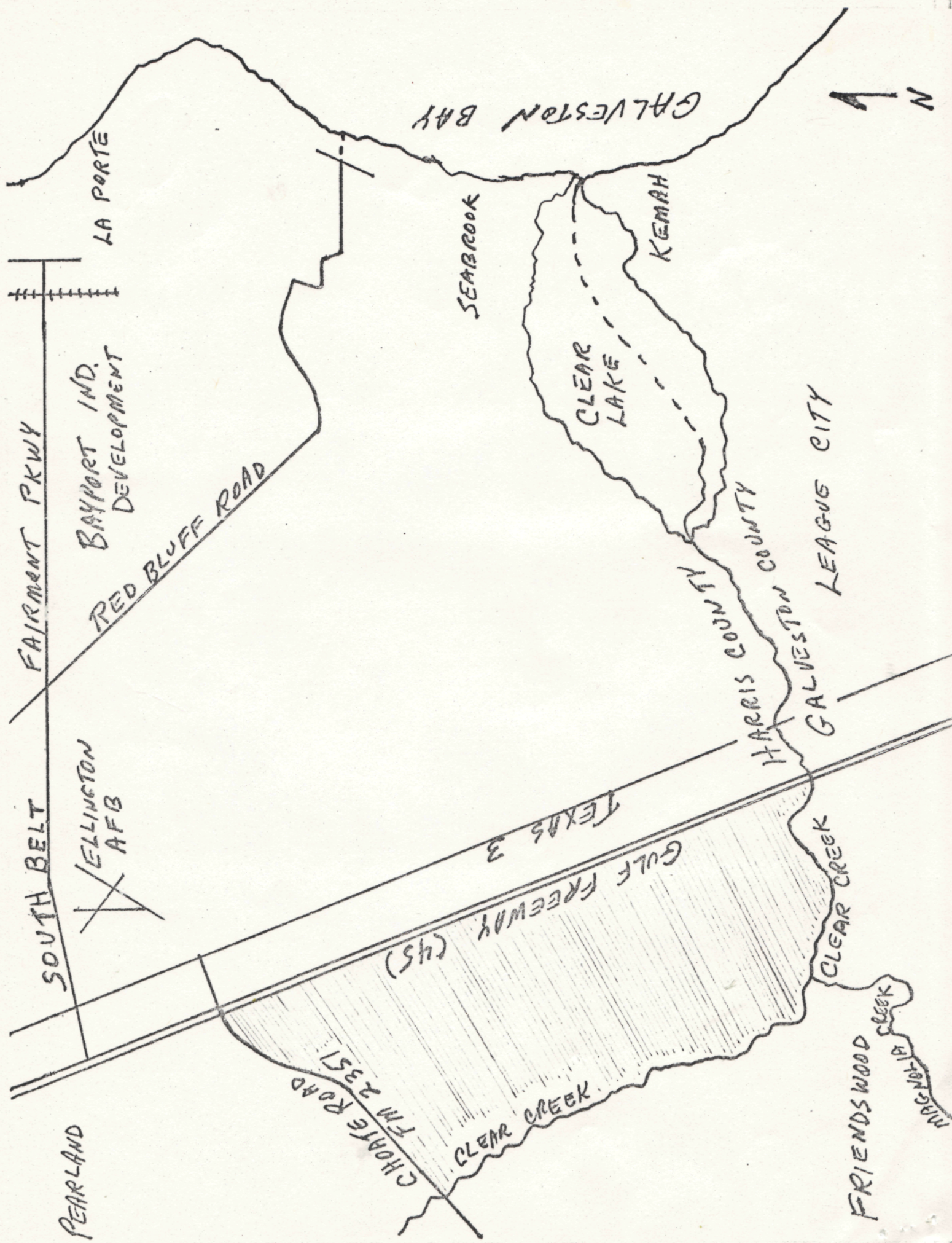

(Member of Rotary International)

Article II Territorial Limits

SECTION 1—The territorial limits of this club are as follows:

Friendswood, Texas and that area bounded on the west by the Brazoria County line; on the north by Clear Cr  ek; on the east by Clear Creek south to Chigger Creek, thence from this point directly south to Dickinson Bayou; on the south Dickinson Bayou.

Object

The object of Rotary is to encourage and foster the ideal of service as a basis of worthy enterprise and, in particular, to encourage and foster:

First. The development of acquaintance as an opportunity for service;
Second. High ethical standards in

active member shall be a person of good character and good business or professional reputation —

(a) engaged as proprietor, partner, corporate officer, or manager of any worthy and recognized business or profession.

(b) being an agent or branch representative of any worthy and recognized business or profession, having charge of such agency or branch in an executive capacity; and

personally and actively engaged in the business or profession in which he is classified in the club and having his place of business or residence located

cally terminate with the termination of the active membership of the active member who proposed him.

(b) The club may, subject to the approval of the holder of the classification, elect to additional active membership in the club any former active member of a Rotary club whose place of business whereat he is actively engaged or whose residence is within the territorial limits of the club and who is otherwise qualified for membership pro-

(1) that there shall, in no case, be more than one additional active member elected under this paragraph of this Section in respect of any one classification, and

(2) that any member so elected shall have terminated membership of his former club only because he ceased to be actively engaged within the territorial limits of that club in the

TERRITORIAL LIMITS

of the

ROTARY CLUB of Space Center (Houston), Texas District 589

Description of Territorial limits	Date Approved By: Board of Directors of R.I.	Notice of Approval Sent To: Club (Copy To Dist. Gov.)
<p>Beginning at the intersection of Red Bluff Road and Fairmont Parkway and thence westerly along Fairmont Parkway to South Belt, thence southwesterly along South Belt to the Gulf Freeway (Interstate 45) and thence southeasterly along the Gulf Freeway to Choate Road (FM 2351), and thence southwesterly along Choate Road to Clear Creek, and thence along the meanders of Clear Creek and the center line of Clear Lake to Kirby Road extended into Clear Lake, thence along Kirby Road to Red Bluff Road, and thence northwesterly along Red Bluff Road to the intersection with Fairmont Parkway and the point of beginning.</p>	<p>Admitted: 6 August 1964</p> <p>Territorial Limits Changed: 20 May 1982</p>	

ITEMS NEEDED IN ORDER TO PREPARE ANY "NOTIFICATION OF ACTION" FORMS
FOR PRESENTATION TO THE BOARD OF DIRECTORS FOR CONSIDERATION:

Following action in accordance with the provisions of Article XIV,
Section 4, of the Rotary club constitution:

1. Notification of Action forms, in triplicate, completed and signed by the club president and secretary.
2. When change is requested for territorial limits, include a large scale map with present and proposed territorial limits clearly identified.
3. Letter from club giving reasons for requested change.
4. Letter of recommendation by district governor.
5. Where Rotary clubs are located in close proximity one to another a statement that by consultation with other clubs in its vicinity and examination of the territorial limits of such clubs in relation to the proposed amendment, the club has ascertained that no conflict with the territorial limits of other clubs would result from the amendment.